

CORNER RECORD

Agency Index

BK 110 PG 89

Document Number

CR 11486

City of OAKLAND

County of ALAMEDA, California

Brief Legal Description MONUMENTS LOCATED WITHIN LINDEN ST
IN FRONT OF 3311 LINDEN ST

CITY OF OAKLAND MON ID: N/A

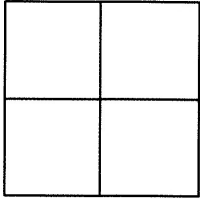

CORNER TYPE

COORDINATES (Optional)

Government Corner ☐ Control ☒
Meander ☐ Property ☐
Rancho ☐ Other ☐

N. _____ E. _____

Elevation _____

Units Metric ☐ U.S. Survey Foot ☐

Horizontal Datum _____

Zone _____ Epoch Date _____

Vertical Datum _____

☐ Complies with Public Resources Code §§8801-8819☐ Complies with Public Resources Code §§8890-8902PLS Act Ref: ☐ 8765(d) ☒ 8771 ☐ 8773 ☐ Other:

Corner/Monument: ☒ Left as found ☐ Established ☐ Rebuilt ☒ Pre-Construction
☐ Found and tagged ☐ Reestablished ☒ Referenced ☐ Post-Construction

Narrative of corner identified and monument as found, set, reset, replaced, or removed:

☐ See sheet #2 for description(s) :

FOUND MONUMENTS AS DESCRIBED ON PAGE 2

FOUND AND SET POINTS AS SHOWN ON PAGE 2.

THIS POINT WAS REFERENCED PRIOR TO A CONSTRUCTION PROJECT IN THE VICINITY.

THE TIES SHOWN HEREON ARE FOR THE PURPOSE OF PERPETUATING FOUND MONUMENTATION.

NO CLAIM IS MADE AS TO THE RELATIONSHIP OF THE POINTS OR LINES SHOWN HEREON TO TRUE
BOUNDARY LOCATION.

SURVEYOR'S STATEMENT

This Corner Record was prepared by me or under my direction in conformance with

the Professional Land Surveyors' Act on JUNE 1, 2018.

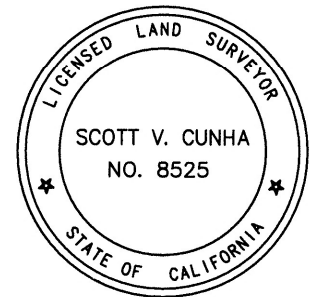
Signed Scott V. Cunha P.L.S. or R.C.E. No. LS 8525
SCOTT V. CUNHA

COUNTY SURVEYOR'S STATEMENT

This Corner Record was received 5 JUNE 2018

and examined and filed 2 AUGUST 2018.

Signed Michael Rubner P.L.S. or R.C.E. No. 16843

Title COUNTY SURVEYOR

County Surveyor's Comment



SCALE: 1"=30'

LEGEND

- FOUND MONUMENT PER CORNER RECORD
- ⊗ FOUND CUT CROSS IN WALK
- ✕ FOUND NAIL & TAG RCE 22573
- ✕ FOUND NAIL NO TAG

AA###A# ALAMEDA COUNTY MONUMENT ID

(19592) REFERENCE STREET ADDRESS

