

# BASIS OF BEARINGS

SOUTH 76°26'20" EAST BETWEEN FOUND UNMARKED 1/2" IRON PIPES ACCEPTED AS THE 1/2" IRON PIPE MARKED LS 3089 SET TO MARK THE NORTH BOUNDARY LINE OF PARCEL 14 AS SHOWN ON MAP CASE 2, DRAWER 14, PAGE 26, MENDOCINO COUNTY RECORDS.

# RECORD INFORMATION

THE BEARINGS AND DISTANCES OF THIS SURVEY AGREE WITH REFERENCED RECORD DATA UNLESS SHOWN OTHERWISE.

RECORD DATA FROM:

- ( ) R1 MAP CASE 2, DRAWER 14, PAGE 26, M.C.R. PARCEL MAP
- ( ) R2 INSTRUMENT NUMBER 2002-20768, M.C.R.

# NOTES

1. THE PURPOSE OF THIS SURVEY IS TO MONUMENT A PORTION OF THE COMMON BOUNDARY LINE OF THE LANDS OF CURTIS DESCRIBED IN INSTRUMENT NUMBER 2005-05812, M.C.R., INSTRUMENT NUMBER 2002-20768, M.C.R. AND THE LANDS OF CARLTON DESCRIBED IN INSTRUMENT NUMBER 2010-07507, M.C.R. AND MARK THAT PORTION IN THE FIELD.
2. THIS MAP CONSTITUTES A BOUNDARY LINE SURVEY ONLY AND DOES NOT SHOW RIGHTS OF WAY, EASEMENTS, OR ENCROACHMENTS OTHER THAN THOSE INDICATED.

# RECORD OF SURVEY

A PORTION OF THE COMMON BOUNDARY LINE OF THE LANDS OF CURTIS DESCRIBED IN INSTRUMENT NUMBER 2005-05812, M.C.R., INSTRUMENT NUMBER 2002-20768, M.C.R. AND THE LANDS OF CARLTON DESCRIBED IN INSTRUMENT NUMBER 2010-07507, M.C.R. LOCATED IN SECTION 31, TOWNSHIP 18 NORTH, RANGE 13 WEST, M.D.B.&M. MENDOCINO COUNTY, SCALE: 1" = 200'

CALIFORNIA  
JAN, 2017

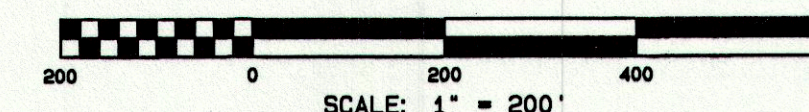

# LEGEND

- SET 1/2" IRON PIPE WITH PLASTIC PLUG MARKED PLS 8335.
- FOUND UNMARKED 1/2" IRON PIPE ACCEPTED AS THE 1/2" IRON PIPE MARKED LS 3089 AS SHOWN ON M.C. 2, D. 14, P. 26, M.C.R.
- △ SET 60d NAIL AND LATH ON BOUNDARY LINE

DISTANCES ARE SHOWN IN FEET AND DECIMALS THEREOF.

**SHN** CONSULTING ENGINEERS  
& GEOLOGISTS  
335 SOUTH MAIN STREET (707)459-4518  
WILLITS, CA 95490 FAX (707)459-1884

# SURVEYOR'S STATEMENT

THIS MAP CORRECTLY REPRESENTS A SURVEY MADE BY ME OR UNDER MY DIRECTION IN CONFORMANCE WITH THE REQUIREMENTS OF THE PROFESSIONAL LAND SURVEYORS' ACT AT THE REQUEST OF CLARK E. CURTIS, III IN AUGUST, 2016.

Matthew T. Herman 3/16/17  
MATTHEW T. HERMAN  
PLS 8335  
LIC. EXP. DATE - 12/31/17



# COUNTY SURVEYOR'S STATEMENT

THIS MAP HAS BEEN EXAMINED IN ACCORDANCE WITH SECTION 8766 OF THE PROFESSIONAL LAND SURVEYORS' ACT THIS 20 DAY OF MARCH, 2017.

BY: Howard N. Dashiell  
HOWARD N. DASHIELL, PLS 7148  
LIC. EXP. DATE 6/30/17  
MENDOCINO COUNTY, CALIFORNIA  
COUNTY SURVEYOR

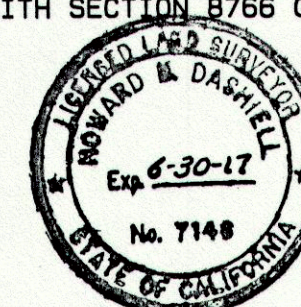

# RECORDER'S STATEMENT

FILED THIS 23 DAY OF March, 2017, AT 3:14 P.M., IN MAPS, DRAWER 816, PAGE 31, M.C.R. AT THE REQUEST OF SHN CONSULTING ENGINEERS & GEOLOGISTS, INC.

BY: Susan M. Ranochak  
SUSAN M. RANOCHAK - COUNTY RECORDER DEPUTY  
FEE \$

Serial # 139  
SHEET 1 OF 1  
MAPS  
DRAWER 816  
PAGE 31

416044

ROS 11-2017