

OMEGA

New numbering of the Omega winding crowns

The crowns are divided into four different types:

1. Crowns with grooving
2. Patent crowns
3. Hermetic crowns
4. Waterproof crowns

A four-figured number is used to denote and classify the crowns.

The first figure indicates the type of crown,

the second figure indicates the diameter of the thread and

the two last figures the order of their production.

Therefore the thread 0.80 mm is represented by the figure 1

"	"	0.90 mm	"	"	"	"	"	2
"	"	1.00 mm	"	"	"	"	"	3
"	"	1.10 mm	"	"	"	"	"	4
"	"	1.20 mm	"	"	"	"	"	5
"	"	square 0.70 mm	"	"	"	"	"	6 (for caliber 440)

Like this a Patent crown, the diameter of the thread of which is 1.00 mm., and 11 the number of the order of production, will bear the number 2311.

When making out your orders for crowns, you should refer to the tables attached hereto which include all the numbers of OMEGA crowns. It is equally indispensable to let us know the metal and the colour of the crowns you desire:

Example: 50 crowns No. 2311, yellow goldfilled.

For your information we set out below the different executions of the crowns utilised (metal-colour)

Steel	Yellow solid gold	}	(for cal: 540)
Yellow gold-filled	Pink solid gold		

Table de conversion des numéros des couronnes
Nouveaux numéros à anciens numéros

Nouveaux numéros	Anciens numéros	Nouveaux numéros	Anciens numéros
Revidées			
1307	90	3402	21
1308	320	3501	54
1401	22	3502	55
1501	42	3503	50
1601	80	3504	52
Patent		Etanches	
* 2102	Wenger, réf.: 2946	* 4101	Wenger 2936
2201	81	4201	689
2202	59	4202	793
2203	83	4203	832
2204	75	4204	817
2207	72	4205	823
2210	57	4206	833
2211	35	4208	608-2.00-0.90
2212	86	4209	669-2.00-0.90
* 2213	85	4210	831
2301	69	4211	829
2303	25	4212	648-2.00-0.90
2309	35	4213	653-2.00-0.90
2311	12	4214	648-2.30-0.90
2402	32	4215	653-2.30-0.90
2503	47	4217	782
		4218	608-2.50-0.90
		4219	669-2.50-0.90
		4220	731
		4222	393
		4223	648-2.50-0.90
		4225	653-2.50-0.90
		4228	788
		4229	839
		4301	834
		4303	608-2.00-1.00
		4304	653-2.00-1.00
		4305	608-2.50-1.00
		4307	653-2.50-1.00
		4308	621
		4310	603
		4402	653-2.50-1.10
		4502	653-2.50-1.20
		4503	837
		4504	695
		4506	633
		4508	200
		4509	628
Hermétiques			
3201	82		
3202	73		
3203	76		
3204	58		
3205	71		
3206	14		
3207	77		
3208	63-2.00-0.90		
3209	18		
3210	17		
3212	19		
3213	20-2.30-0.90		
3214	56		
3301	74		
3302	60		
3303	67		
3304	65		
3305	63-2.00-1.00		
3308	28-2.30-1.00		
3309	20-2.30-1.00		

* S'exécute seulement en or massif

Table de conversion des numéros des couronnes
Anciens numéros à nouveaux numéros

Anciens numéros		Nouveaux numéros	Anciens numéros		Nouveaux numéros
12	P	2311	86	P	2212
14	H	3206	90	R	1307
17	H	3210	200	E	4508
18	H	3209	320	R	1308
19	H	3212	393	E	4222
20-2.30-0.90	H	3213	603	E	4310
20-2.30-1.00	H	3309	608-2.00-0.90	E	4208
21	H	3402	608-2.50-0.90	E	4218
22	R	1401	608-2.00-1.00	E	4303
25	P	2303	608-2.50-1.00	E	4305
28-2.30-1.00	H	3308	621	E	4308
32	P	2402	628	E	4509
35-0.90	P	2211	633	E	4506
35-1.00	P	2309	648-2.00-0.90	E	4212
			648-2.30-0.90	E	4214
42	R	1501	648-2.50-0.90	E	4223
47	P	2503	653-2.00-0.90	E	4213
50	H	3503	653-2.30-0.90	E	4215
52	H	3504	653-2.50-0.90	E	4225
54	H	3501	653-2.00-1.00	E	4304
55	H	3502	653-2.50-1.00	E	4307
56	H	3214	653-2.50-1.10	E	4402
57	P	2210	653-2.50-1.20	E	4502
58	H	3204	669-2.00-0.90	E	4209
59	P	2202	669-2.50-0.90	E	4219
60	H	3302	689	E	4201
63-2.00-0.90	H	3208	695	E	4504
63-2.00-1.00	H	3305	731	E	4220
65	H	3304	782	E	4217
67	H	3303	788	E	4228
69	P	2301	793	E	4202
71	H	3205	817	E	4204
72	P	2207	823	E	4205
73	H	3202	829	E	4211
74	H	3301	831	E	4210
75	P	2204	832	E	4203
76	H	3203	833	E	4206
77	H	3207	834	E	4301
80	R	1601	837	E	4503
81	P	2201	839	E	4229
82	H	3201	* Wenger 2936	E	4101
83	P	2203	* Wenger 2946	P	2102
* 85	P	2213			

* S'exécute seulement en or massif

R = revidée

P = patent

H = hermétique

E = étanche

Couronnes revidées - Crowns with grooving - Coronas ahuecadas
Kronen mit Aushöhlung - Corone scavate

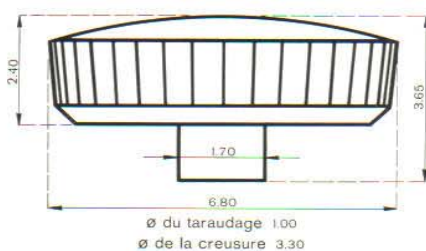

1307

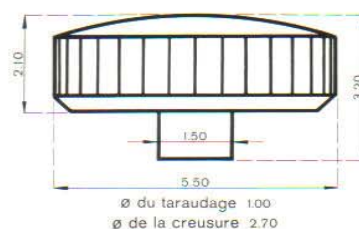

1308

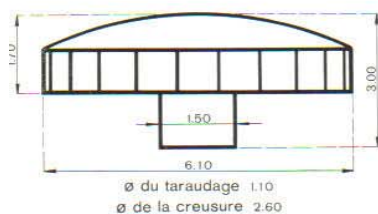

1401

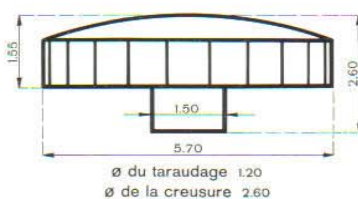

1501

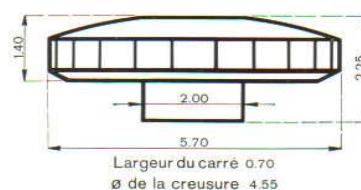

1601

Les mesures indiquées sur ces plans sont en millimètres
Measures on these plans are indicated in millimetres
Las medidas en estos planos son en milímetros

Couronnes Patent - Patent crowns - Coronas Patent
Patent-Kronen - Corone Patent

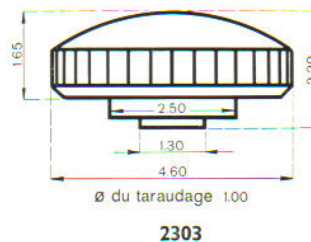
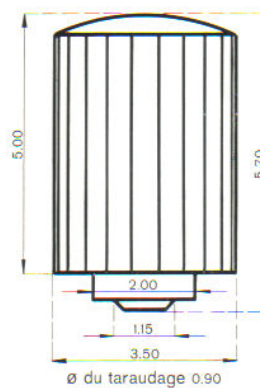
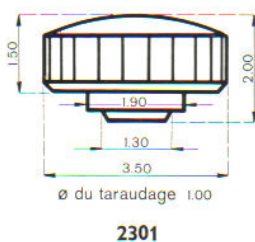
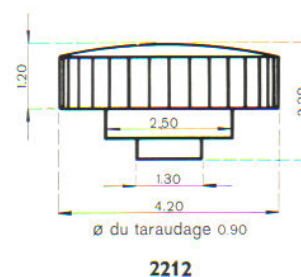
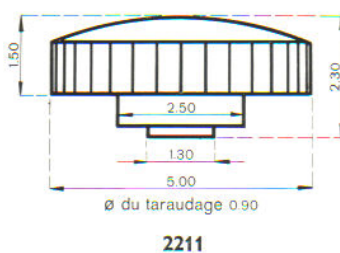
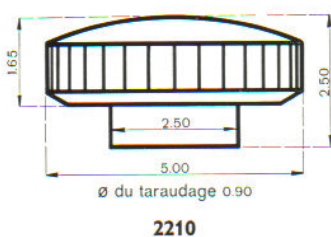
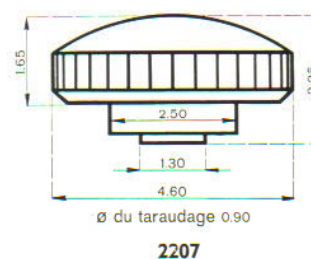
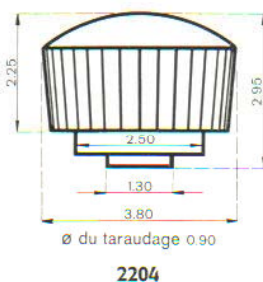
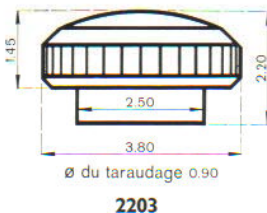
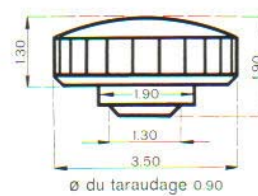
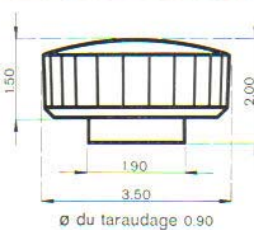
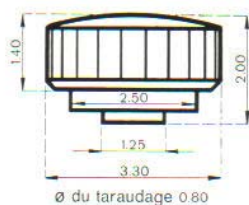
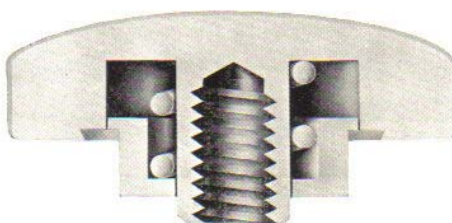

Couronnes Patent - Patent crowns - Coronas Patent
Patent-Kronen - Corone Patent

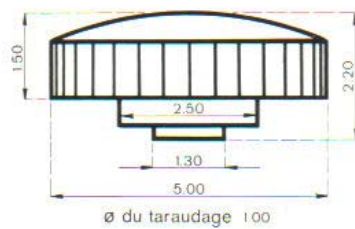

2309

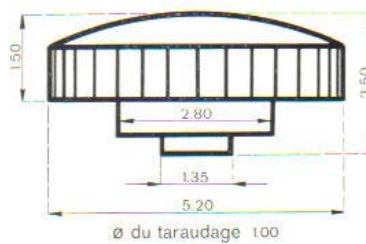

2311

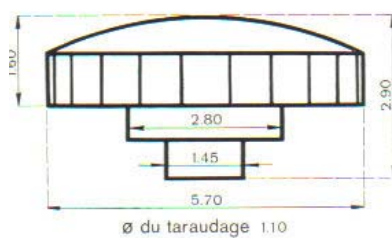

2402

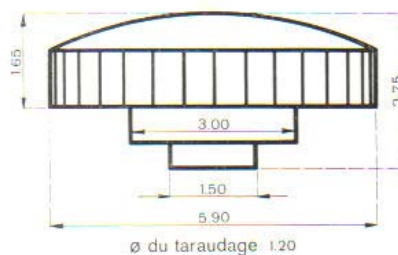

2503

Couronnes hermétiques - Hermetic crowns - Coronas herméticas
Hermetische Kronen - Corone ermetiche

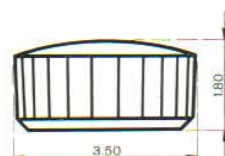
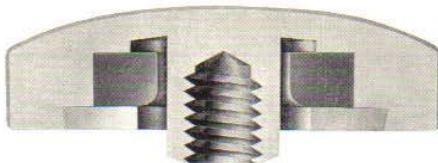

ø du taraudage 0.90
ø du tube de la boîte 2.00

3201

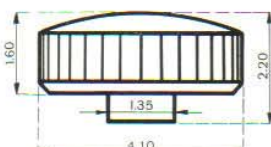

ø du taraudage 0.90
ø du tube de la boîte 2.00

3202

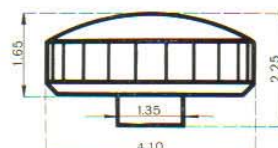

ø du taraudage 0.90
ø du tube de la boîte 2.00

3203

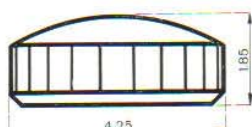

ø du taraudage 0.90
ø du tube de la boîte 2.00

3204

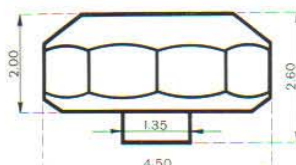

ø du taraudage 0.90
ø du tube de la boîte 2.00

3205

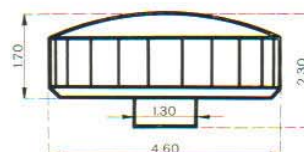

ø du taraudage 0.90
ø du tube de la boîte 2.00

3206

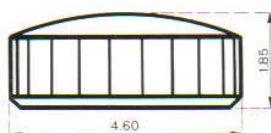

ø du taraudage 0.90
ø du tube de la boîte 2.00

3207

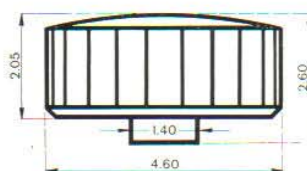

ø du taraudage 0.90
ø du tube de la boîte 2.00

3208

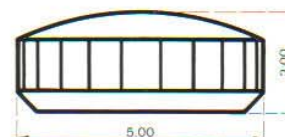

ø du taraudage 0.90
ø du tube de la boîte 2.00

3209

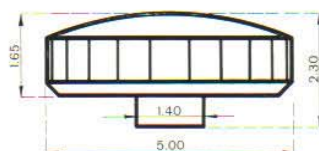

ø du taraudage 0.90
ø du tube de la boîte 2.00

3210

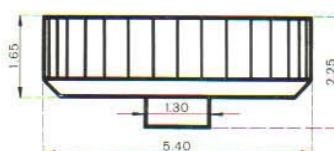

ø du taraudage 0.90
ø du tube de la boîte 2.30

3212



ø du taraudage 1.00
ø du tube de la boîte 2.30

3213

Les mesures indiquées sur ces plans sont en millimètres
Measures on these plans are indicated in millimetres
Las medidas en estos planos son en milímetros
Die Maße auf diesem Plan sind in Millimetern angegeben
Le misure indicate sui piani sono in millimetri

Couronnes hermétiques - Hermetic crowns - Coronas herméticas
Hermetische Kronen - Corone ermetiche

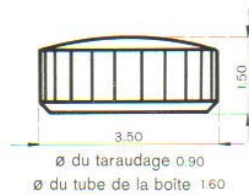

3214

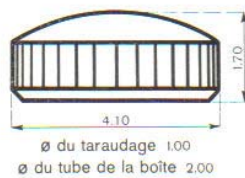

3301

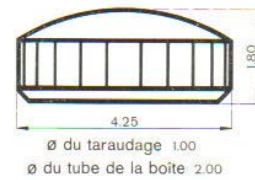

3302

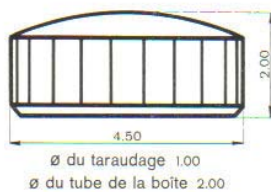

3303

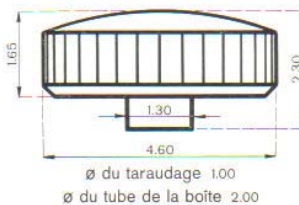

3304

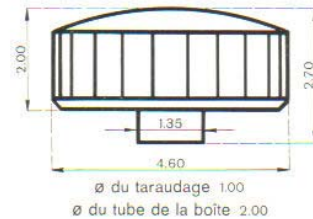

3305

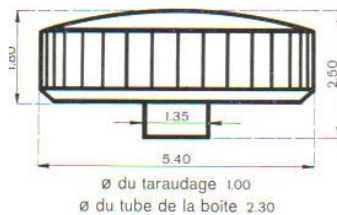

3308

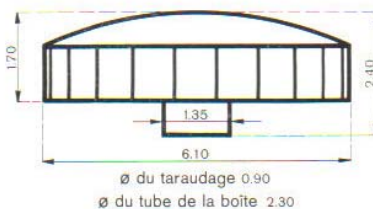

3309

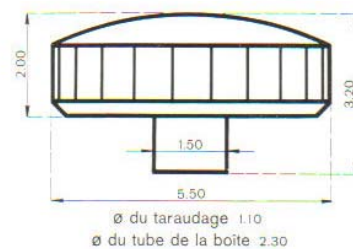

3402

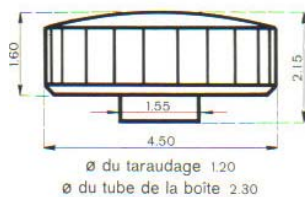

3501

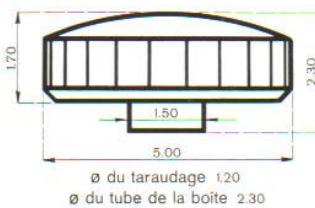

3502

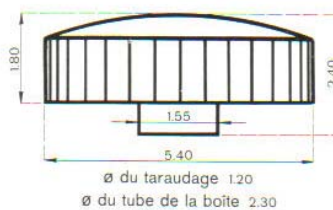

3503

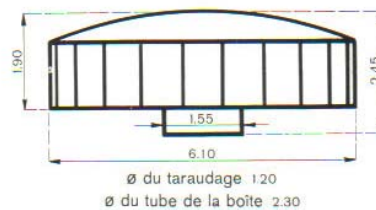

3504

**Couronnes étanches - Waterproof crowns - Coronas impermeables
Wasserdichte Kronen - Corone impermeabili**

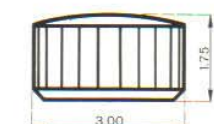
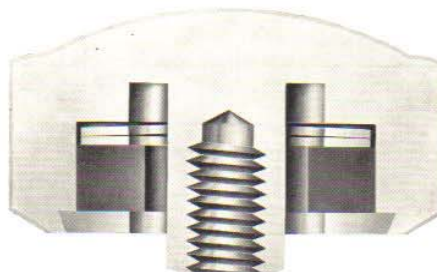

Ø du taraudage 0.80
Ø du tube de la boîte 1.60

4101

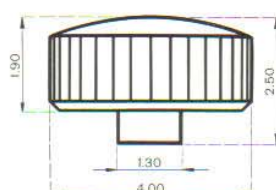

Ø du taraudage 0.90
Ø du tube de la boîte 2.00

4201



Ø du taraudage 0.90
Ø du tube de la boîte 2.00

4202

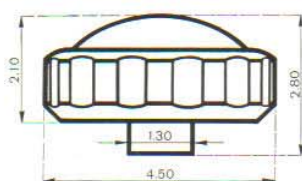

Ø du taraudage 0.90
Ø du tube de la boîte 2.00

4203

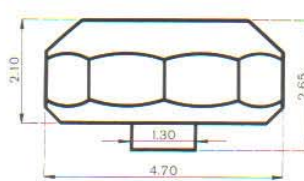

Ø du taraudage 0.90
Ø du tube de la boîte 2.00

4204

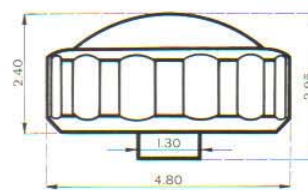

Ø du taraudage 0.90
Ø du tube de la boîte 2.00

4205

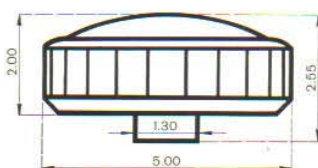

Ø du taraudage 0.90
Ø du tube de la boîte 2.00

4206

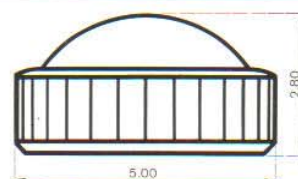

Ø du taraudage 0.90
Ø du tube de la boîte 2.00

4208

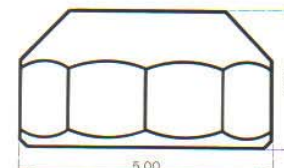

Ø du taraudage 0.90
Ø du tube de la boîte 2.00

4209

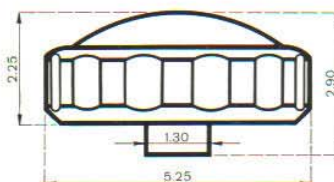

Ø du taraudage 0.90
Ø du tube de la boîte 2.00

4210

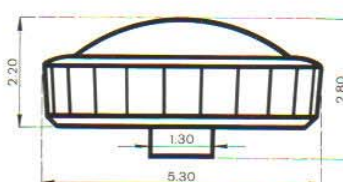

Ø du taraudage 0.90
Ø du tube de la boîte 2.00

4211

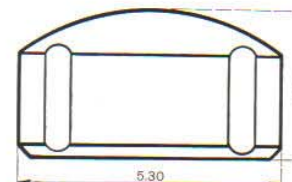

Ø du taraudage 0.90
Ø du tube de la boîte 2.00

4212

Les mesures indiquées sur ces plans sont en millimètres.
Measures on these plans are indicated in millimetres
Las medidas en estos planos son en milímetros
Die Maße auf diesem Plan sind in Millimetern angegeben
Le misure indicate sui piani sono in millimetri

Couronnes étanches - Waterproof crowns - Coronas impermeables
Wasserdichte Kronen - Corone impermeabili

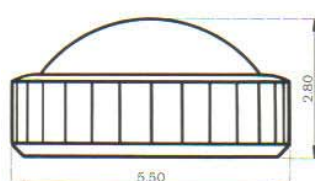

ø du taraudage 0.90
ø du tube de la boîte 2.00

4213

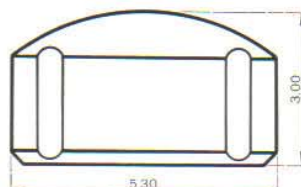

ø du taraudage 0.90
ø du tube de la boîte 2.30

4214

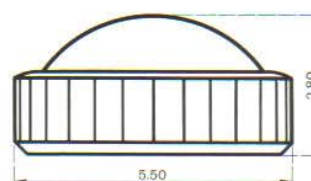

ø du taraudage 0.90
ø du tube de la boîte 2.30

4215

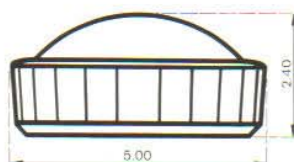

ø du taraudage 0.90
ø du tube de la boîte 2.50

4217

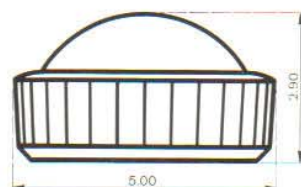

ø du taraudage 0.90
ø du tube de la boîte 2.50

4218

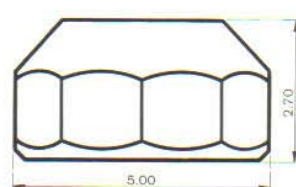

ø du taraudage 0.90
ø du tube de la boîte 2.50

4219

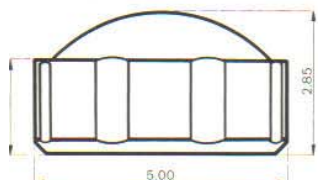

ø du taraudage 0.90
ø du tube de la boîte 2.50

4220

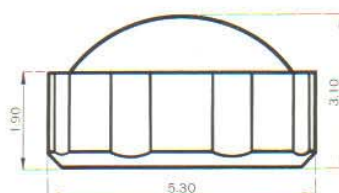

ø du taraudage 0.90
ø du tube de la boîte 2.50

4222

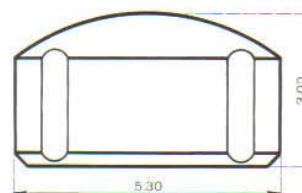

ø du taraudage 0.90
ø du tube de la boîte 2.50

4223

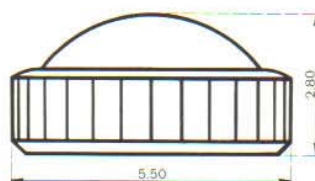

ø du taraudage 0.90
ø du tube de la boîte 2.50

4225

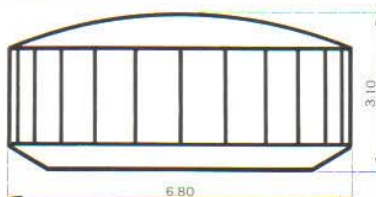

ø du taraudage 0.90
ø du tube de la boîte 2.50

4228

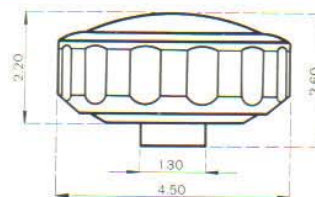

ø du taraudage 0.90
ø du tube de la boîte 2.00

4229

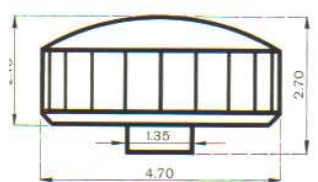

ø du taraudage 1.00
ø du tube de la boîte 2.00

4301

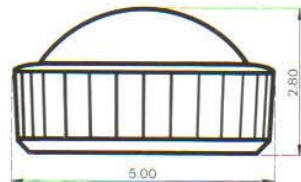

ø du taraudage 1.00
ø du tube de la boîte 2.00

4303

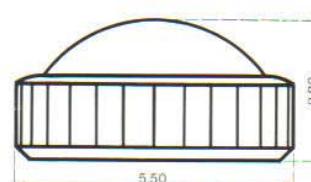

ø du taraudage 1.00
ø du tube de la boîte 2.00

4304

Couronnes étanches - Waterproof crowns - Coronas impermeables
Wasserdichte Kronen - Corone impermeabili

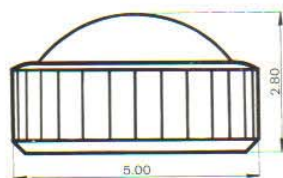

Ø du taraudage 1.00
Ø du tube de la boîte 2.50

4305

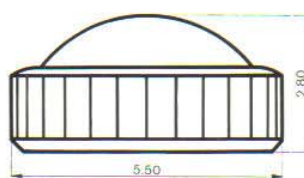

Ø du taraudage 1.00
Ø du tube de la boîte 2.50

4307

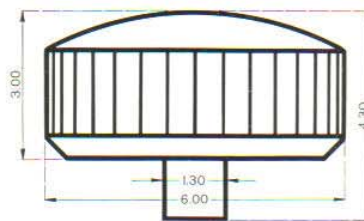

Ø du taraudage 1.00
Ø du tube de la boîte 2.50

4308

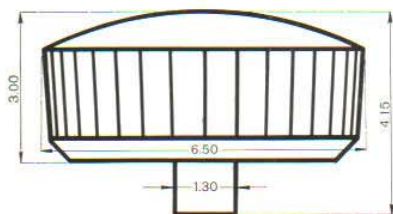

Ø du taraudage 1.00
Ø du tube de la boîte 2.50

4310

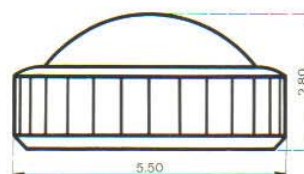

Ø du taraudage 1.10
Ø du tube de la boîte 2.50

4402

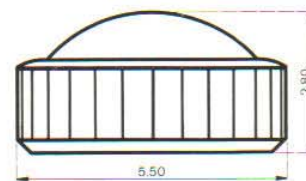

Ø du taraudage 1.20
Ø du tube de la boîte 2.50

4502

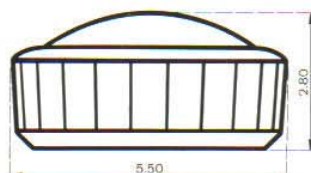

Ø du taraudage 1.20
Ø du tube de la boîte 2.50

4503

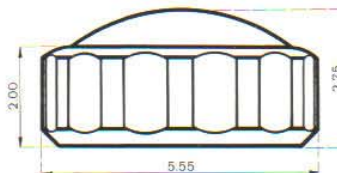

Ø du taraudage 1.20
Ø du tube de la boîte 2.50

4504

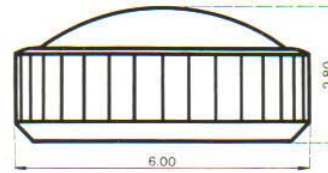

Ø du taraudage 1.20
Ø du tube de la boîte 2.50

4506

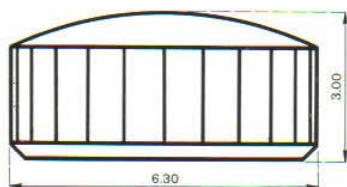

Ø du taraudage 1.20
Ø du tube de la boîte 2.50

4508

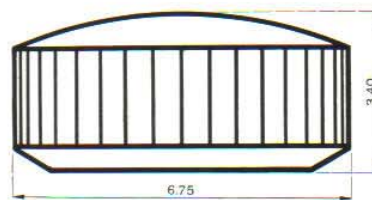

Ø du taraudage 1.20
Ø du tube de la boîte 2.50

4509

